

**SANTA CLARA
COUNTY PARKS**

A collaborative
planning project with



Public Notice

Martial Cottle Park Master Plan

The Santa Clara County Parks Department will be holding its fourth community workshop/public meeting related to the planning of Martial Cottle Park located in South San Jose, Santa Clara County. At this meeting, the Draft Report for a combined Martial Cottle Park State Park General Plan and County Park Master Plan ("Park Plan") will be presented and the public will have an opportunity to provide comments. A portion of this public meeting will also serve as a scoping meeting to solicit public input on the potential environmental impacts associated with the project.

Community Workshop #4/ Draft Environmental Impact Report (DEIR) Public Scoping Meeting will be held on Wednesday, February 10, 2010, from 6:30 to 8:30 p.m. at the Forum/Cafeteria at Gunderson High School, 622 Gaundabert Lane, San Jose, California, 95136.

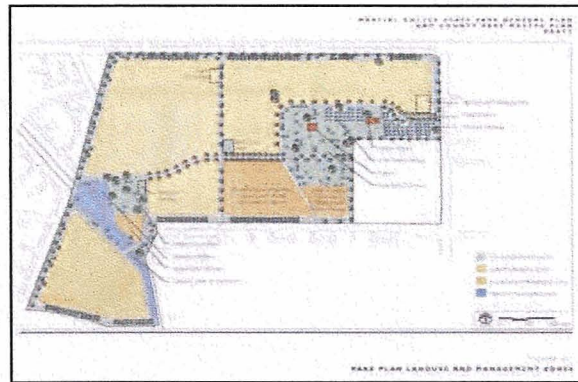

Project Location

The Santa Clara County Parks Department and California State Parks jointly own Martial Cottle Park. This future park is a 287.54-acre property adjacent to Highway 85, bounded by Branham Lane, Snell Avenue and Chynoweth Avenue. In accordance with the property transfer agreement with the Donor of the Park, the County and the State are engaged in a collaborative planning process to develop a plan that is consistent with the Donor's Vision for a historic agricultural park.

Purpose of Workshop and Public Scoping Meeting

Members of the community and interested agency representatives are invited to the Community Workshop/ DEIR Public Scoping meeting to learn more about the Park Plan. In accordance with California Environmental Quality Act (CEQA) guidelines, the County Parks Department will prepare a draft Environmental Impact Report (EIR) for the project to evaluate the project's potential environmental impacts on the park and surrounding area. We are interested in receiving general public comments on the scope and content of the environmental document. Once a Draft EIR is prepared, members of the public are invited to submit written comments during the 45-day public review and comment period.

Throughout this planning process, members of the public are encouraged to share ideas and suggestions on future public uses, opportunities and planning issues for consideration in the Martial Cottle Park planning project.

For additional project information, please visit <http://www.parkhere.org> (Click on "Martial Cottle Park Master Plan Project.")

Jane Mark, Senior Planner/ Project Manager
jane.mark@prk.sccgov.org
(408) 355-2237

Kimberly Brosseau, Park Planner
Kimberly.brosseau@prk.sccgov.org
(408) 355-2230