

Albertson Parkway and Neighborhood Walkways

by
Ronald Horii

Origin of the Name

The Albertson Parkway was named after Gary Albertson, the leader of the group fighting for a freeway bypass to Monterey Highway, a deadly strip of road known as "Blood Alley." Ironically, Albertson and 4 others were killed in a head-on crash on Monterey Highway in 1974. The park strip was named to memorialize Albertson, who lived in the neighborhood.

The Albertson Parkway is an 80-foot wide strip of mostly undeveloped land under the PG&E power towers that supply the Hitachi plantsite.



The Albertson Parkway runs from Dondero Way and Cresta Vista Way near Santa Teresa School to Curie Drive and Manila Way near Santa Teresa County Park.



What is in the Albertson Parkway Now?

- Straight sidewalks
 - Fences
 - Trail gates
 - Power towers
 - A few trees
-
- Dirt
 - Weeds
 - Litter

Albertson Parkway from Cresta Vista Way near Dondero Way



Albertson Parkway at Esteban Way & Moraga Way



Albertson Parkway Before Solano Drive



Albertson Parkway at Solano Drive



Albertson Parkway at San Anselmo Way



Albertson Parkway at Jaggers Drive



End of Albertson Parkway at Curie Drive & Manila Way



Where does the
Albertson
Parkway lead
to?

The Santa Teresa County Park Historic Area and Hiking Trails

Bear Tree Lot, Curie Drive Santa Teresa County Park



Santa Teresa Spring at Manila Way & Manila Drive

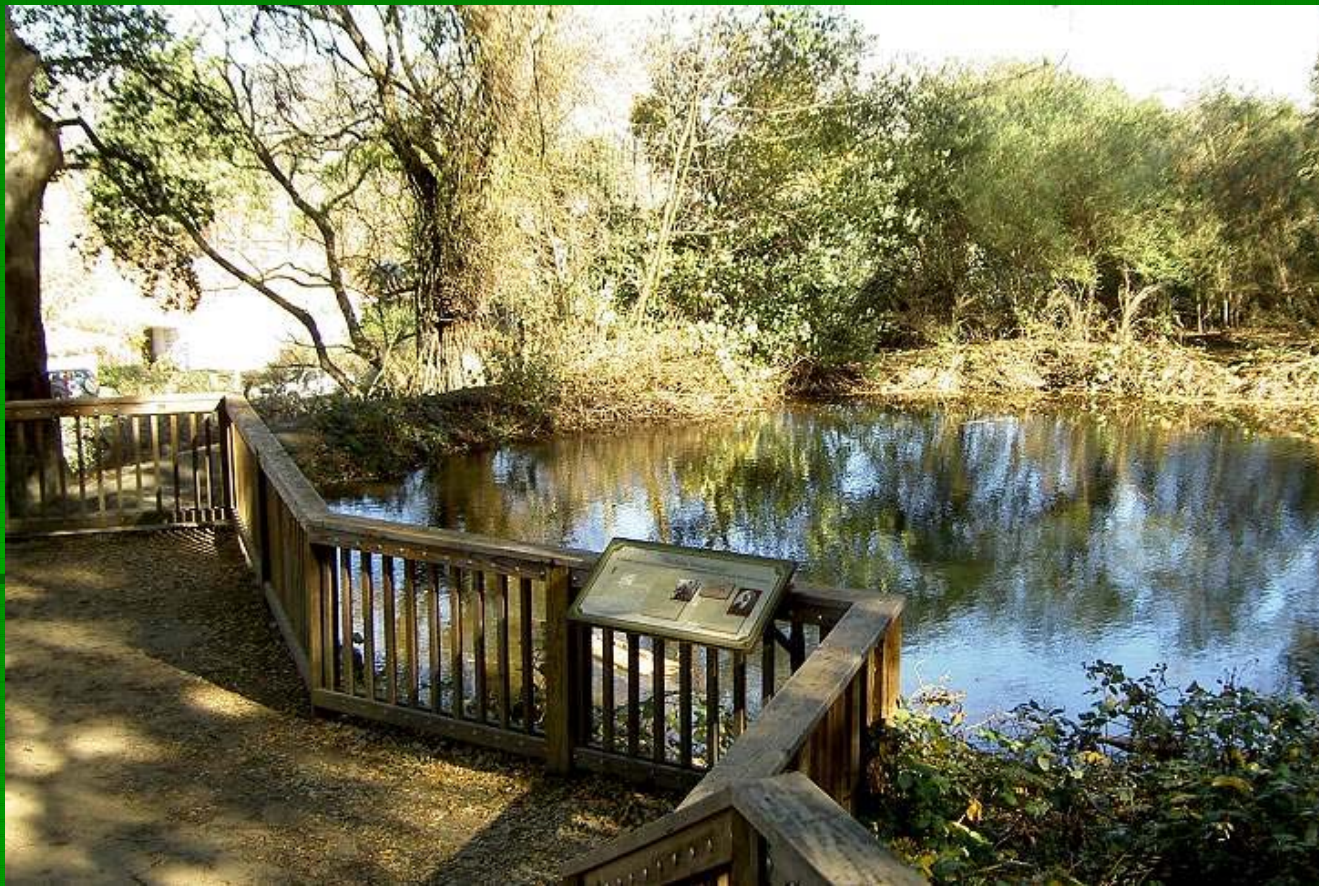

Bernal-Gulnac-Joice Ranch on Manila Drive



Joice Trail, Santa Teresa County Park



Bernal Hill, Santa Teresa County Park



Ideas for the Albertson Parkway: Other Neighborhood Walkways

Walkway to Los Paseos Park



Los Paseos Walkway



Los Paseos Walkway



Los Paseos Walkway



Avenida Espana-Bayliss Drive Walkway



Avenida Espana-Bayliss Drive Walkway



Walkway Entrance at Cheltenham Way to Avenida Espana



Mid-way on Cheltenham-Avenida Espana Walkway



Mid-way on Cheltenham- Avenida Espana Walkway



Walkway Entrance: Avenida Espana at Via Vista



Basking Ridge



Evergreen Valley Walkway



Evergreen Valley Parkway

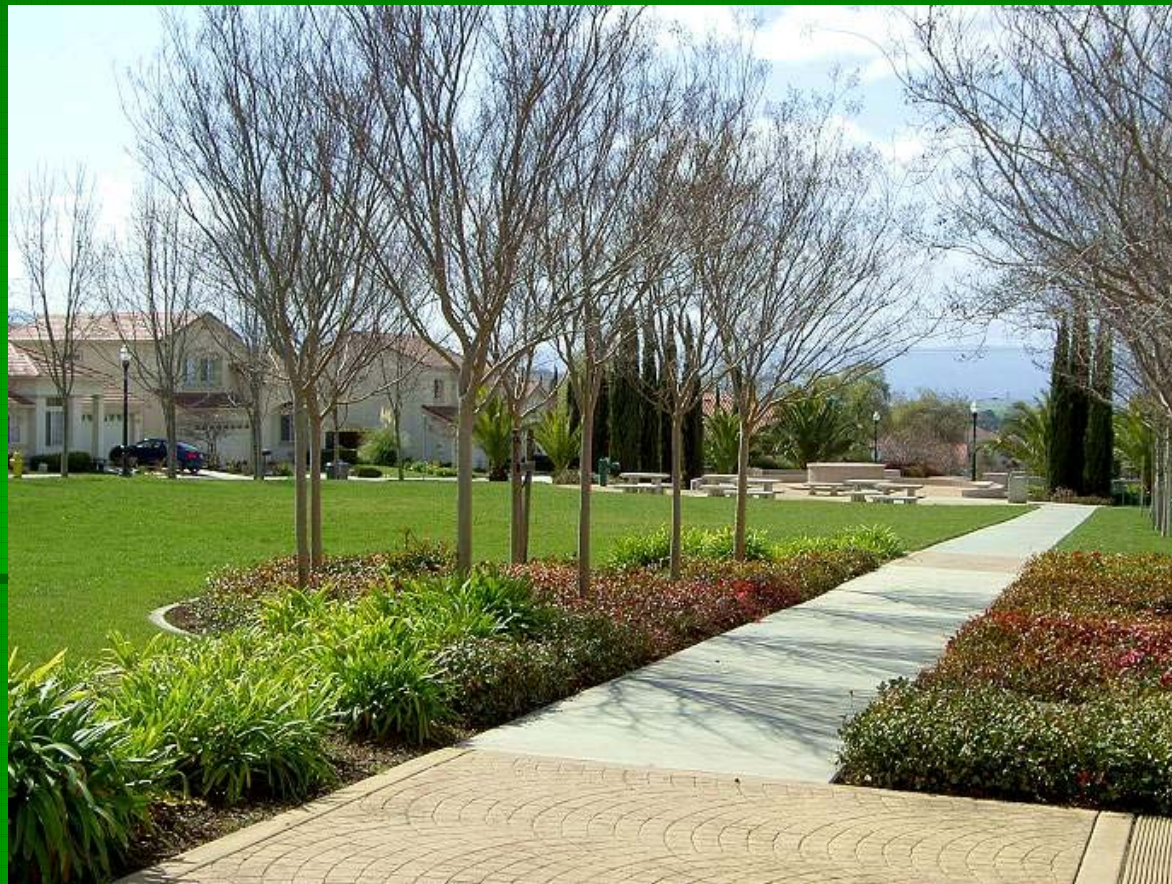

Dogpark and Trail at Fontana Park, Almaden Valley

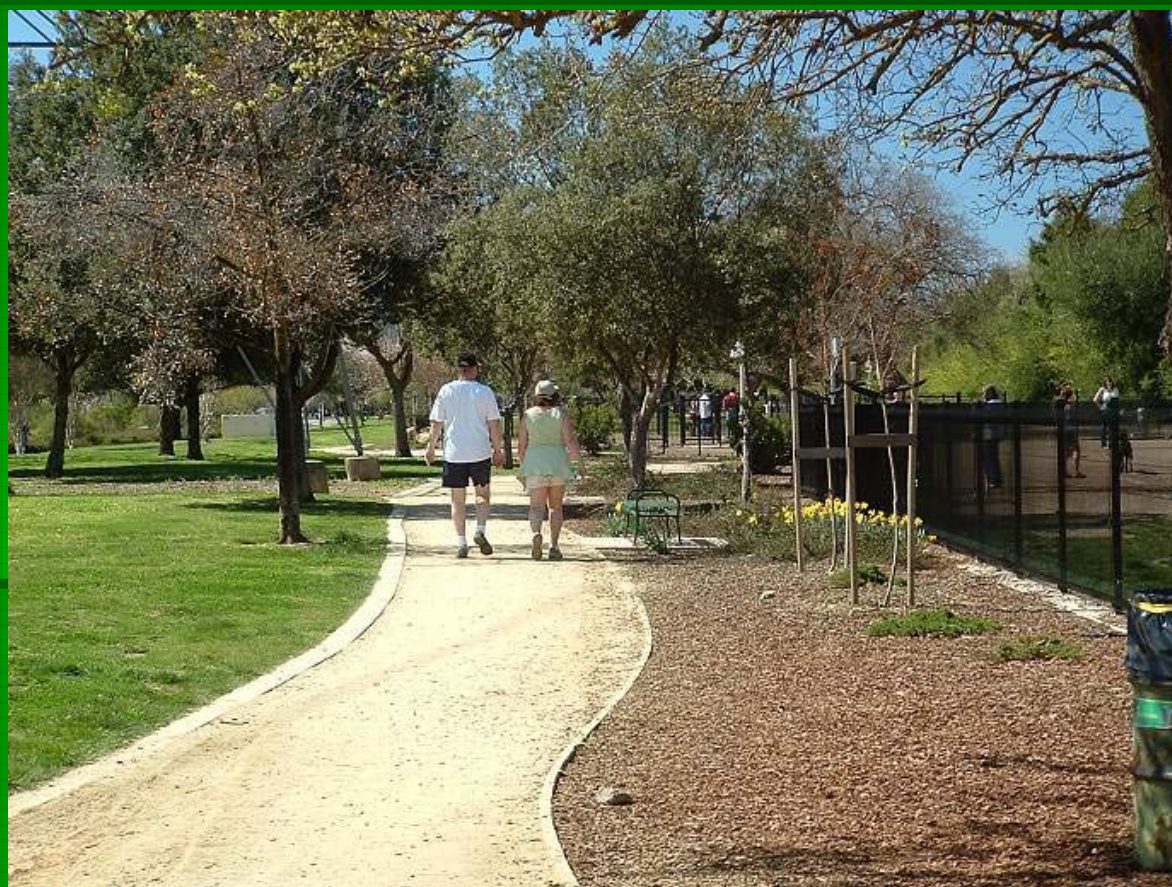

Fontana Park Playground



Cilker Park, Guadalupe River Trail by Chynoweth



Communications Hill



Live Oak Manor Park, Los Gatos



Mini-Park on Winchester Blvd., Campbell

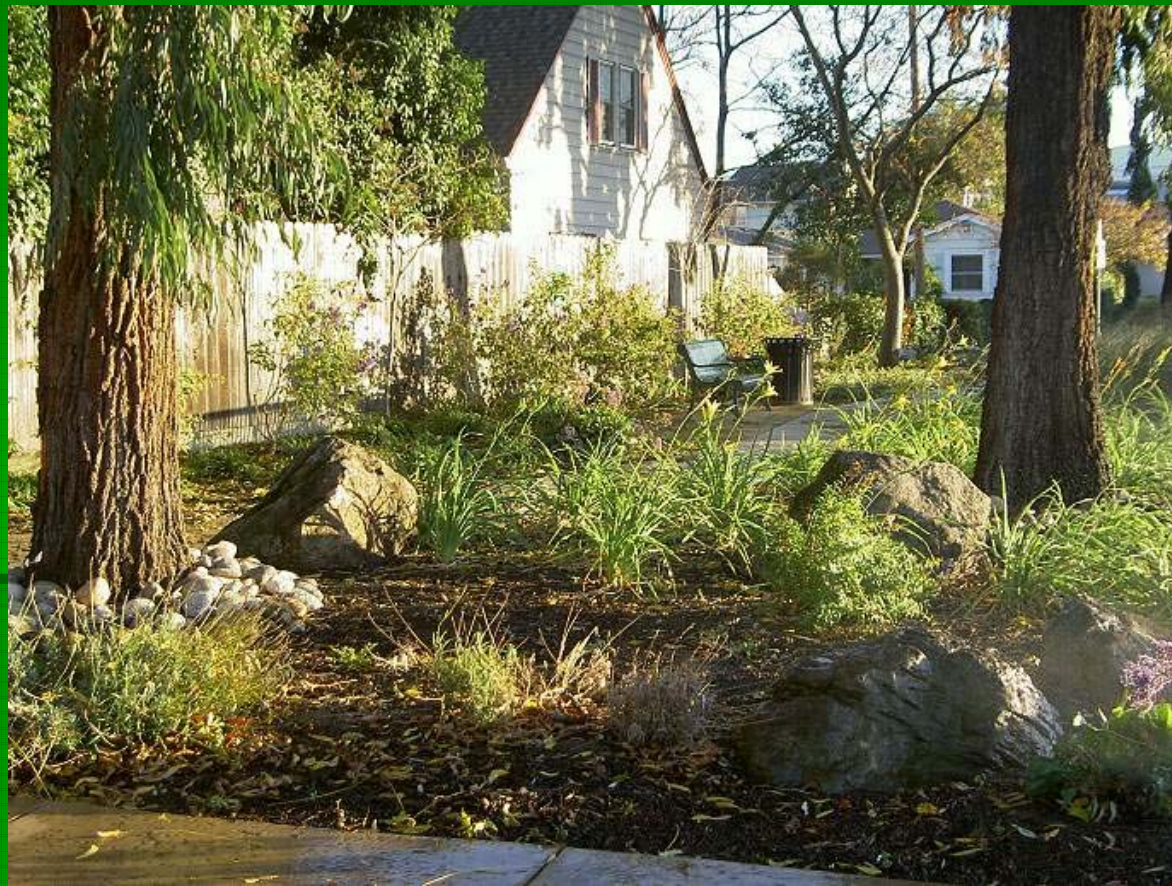

JW Christian Greenbelt, Sunnyvale



Orchard Garden Park, Sunnyvale



Hetch Hetchy Trail, Mountain View



Stanford Neighborhood Walkway



Stanford Neighborhood Walkway



Bay Trail: Redwood City Seaport Blvd. Walkway



Bay Trail: Pacific Shores Center, Redwood City



Redwood Shores Bay Trail



Ideas for the Albertson Parkway

- Winding paths, crushed stone instead of asphalt
- Trees, bushes, flowers, lawns, ground cover
- Community gardens
- Benches, picnic tables, shade structures
- Drinking fountains, decorative fountains, ponds
- Interpretive signs, bulletin boards
- Sign pointing to Santa Teresa Park
- Play areas, fitness course
- Trash cans, pooper scoopers
- Lighting, emergency call boxes
- Easier bicycle access
- Crosswalks between segments